

**MZ21**

*DISC PTC*

**Features**

- Chips ceramic PTC

**Product Dimensions (mm)**

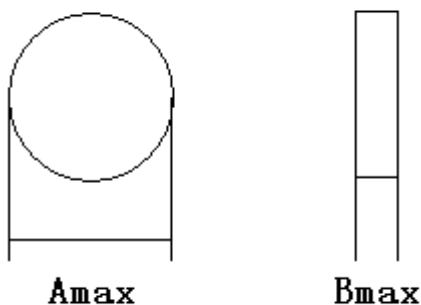

| Type | Amax<br>mm | Bmax<br>mm |
|------|------------|------------|
| MZ21 | 8.2        | 1.5        |

**Electrical characteristics**

| No. | Item | Test       |   |
|-----|------|------------|---|
| 1   | R0   | 25°C±2°C   | 14-19Ω  |
| 2   | R80  | 80°C±2°C   | <60Ω  |
| 3   | R95  | 95°C±2°C   | 23~120Ω   |
| 4   | R160 | >160°C     | >300KΩ  |
| 5   | VR   | -30°C~80°C | 0.2Vdc  |
| 6   | VMAX | 16Vdc      | Max voltage device can withstand without damage     |
| 7   | TC   | 80°C       | Curie temperature                                   |
| 8   | TMAX | 180°C      | Max temperature device can withstand without damage |

**Packaging&Marking**

Bulk Packing